

Monostable Reed contact

MRK 10



MRK 10 P 34 Monostable Reed contact
mounted on glass sight level indicator GNR5

Safety Precautions

- Installation, initial start-up and maintenance may only be performed by trained personnel!
- The device may only be connected to the supply voltage specified in the technical data!
- The device must be disconnected from all sources of power during installation and maintenance work!
- The device may only be operated under the conditions specified in the operating instructions!

CE- Marks

In accordance with low-voltage directive (2006/95/EC) and EMC directive (2004/108/EC)

Technical Data

Housing	Stainless steel 1.4571
Clip	Stainless steel 1.4401 for tubes dia 32 to 34
Cable	PVC 2x0,5 mm ² or Silicone rubber 2x0,75 mm ² Length approx. 2m
Contacts	monostable Reed contact (NO)
Rated Voltage	max. 30V AC/DC
Rated Power	max. 10VA
Ambient Temperature	-15 ... +70°C with silicone rubber -15 ... +130°C

Dimensions

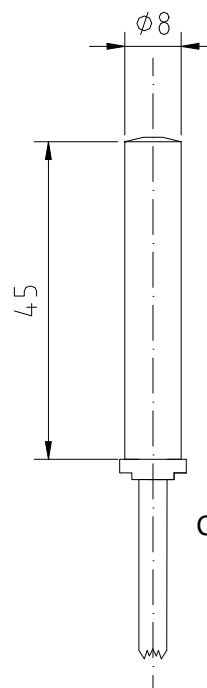

Cable length approx. 2m