

# Sight glass level indicator GNR5 / GRN5C



GNR5



GNR5 C



## SAFETY INSTRUCTIONS

- Installation, commissioning and maintenance may only be performed by qualified personnel!
- The device may only be operated under the conditions specified in the operating instructions!

## DESCRIPTION

Connected to a container, the GNR5... indicates its fill level by means of a float. It is possible to see the current fill level of the medium through the sight glass. In addition, the optionally available BSM 502 bistable contacts can be used to realise limit value settings.

## TECHNICAL DATA

Shut-off valves	Brass nickel-plated (GNR5), stainless steel (GNR5 C)
Flanges (optional)	GNR5: Steel GNR5 C: Stainless steel loose flanges DIN 2641 PN10 with plain or flanged bushes Stainless steel flanges DIN EN 1092-1 Type 02 Form A PN40, DN20 / DN25
Sight glass	Duran Ø34.5x2.75
Float	PP (S5/d25)
Seals GNR5	Between valve and glass tube: Silicone rubber (Optional NBR) inside the valve: EPDM
Seals GNR5C	Between valve and glass tube: Silicone rubber (Optional NBR) inside the valve: EPDM/PTFE (Optional NBR/PTFE)
Impact protection	PVC transparent
Drain cock	Brass (GNR5, stainless steel (GNR5C))
Operating temperature	0- 110 °C (120 °C for a short time)
Working overpressure	max. 1bar at 110 °C max. 4bar at 20 °C
Centre distance ME	min. 300mm max. 2000mm
Process connection	Stainless steel G1/2", G3/4", G1" or loose flanges DN20 or DN25
Accessories	Limit switch BSM 502

**CE marking: No labelling according to Article 4, Paragraph 3 of the Pressure Equipment Directive (2014/68/EU)**

**BAMO** INTERNATIONAL

22, Rue de la Voie des Bans · Z.I. de la gare · 95100 ARGENTEUIL

Tel +33 (0)1 30 25 83 20 Web [www.bamo.eu](http://www.bamo.eu)

Fax +33 (0)1 34 10 16 05 E-mail [export@bamo.fr](mailto:export@bamo.fr)

Sight glass level indicator  
**GNR5 / GRN5C**

07-11-2024

M-570.02-EN-AB

LEV

570-02/1

## PRESSURE-TEMPERATURE DIAGRAM

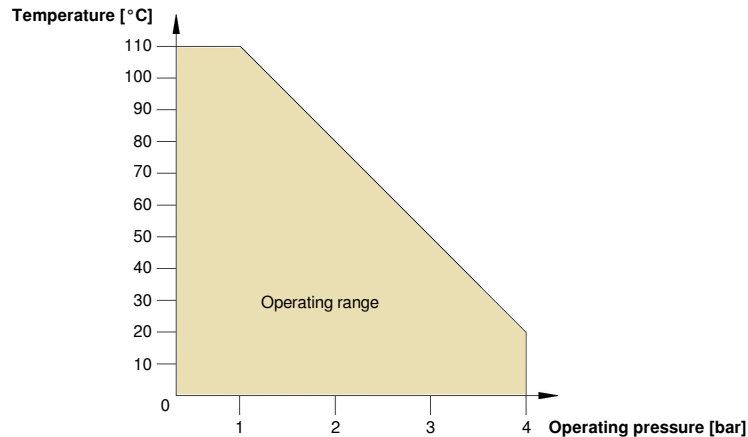

## PLEASE NOTE

- Only use for highly fluid media that do not tend to stick, encrust or crystallise. The media must not contain any magnetisable particles (chips).
- Only use float type S5/25d.
- Install the float so that the "TOP" marking faces upwards.
- Observe the maximum temperature and pressure load.
- Do not install at an angle! The centre distance and angularity of the flanges/threaded sockets should be checked before installing the glass tube.
- Observe the arrangement of the sealing rings during installation (see next page).

## ASSEMBLY SEQUENCE

### GNR5... with flange connection:

- Install the upper and lower shut-off valve with a suitable seal on the tank flange  
Do not tighten the screws completely yet
- Insert silicone disc 11x12x5 into the stopcocks
- Slide the hose clamps for the impact protection fastening and the union nuts including the internally engaged silicone ring onto the standpipe
- Insert the standpipe angular between the stopcocks
- Check standpipe length! The glass tube must be flush with the silicone discs; if necessary, loosen the flange screws and correct the distance/angle
- Tighten the flange screws again
- Slide the union nuts to the stopcock and screw on
- Then tighten the union nut with force (spanner size 46) until the silicone ring is in contact with the glass tube at all points!
- If necessary, fit BSM 502 bistable switches
- Fitting transparent impact protection
- After filling the tank, check all screw connections for leaks!

### GNR5... with threaded connection:

- Mount the upper and lower stopcock on the threaded tank connection using suitable sealing material
- Insert silicone disc 11x12x5 into the stopcocks
- Attach the hose clamps for the impact protection fastening and the union nuts including the internally engaged silicone ring to the standpipe (see Fig. 2)
- Insert the standpipe angular between the stopcocks
- Check the standpipe length! The pipe must be flush with the silicone discs, adjust if necessary
- Slide the union nuts to the stopcock and screw on
- Then tighten the union nut with force (spanner size 46) until the silicone ring is in contact with the glass tube at all points!

### Remark:

The glass tube can only break if it is installed at an angle or if brute force is used.

- If necessary, fit BSM 502 bistable switches
- Fitting transparent impact protection
- After filling the tank, check all screw connections for leaks!

**BAMO** INTERNATIONAL

22, Rue de la Voie des Bans · Z.I. de la gare · 95100 ARGENTEUIL

Tel +33 (0)1 30 25 83 20 Web [www.bamo.eu](http://www.bamo.eu)

Fax +33 (0)1 34 10 16 05 E-mail [export@bamo.fr](mailto:export@bamo.fr)

Sight glass level indicator  
**GNR5 / GRN5C**

LEV

570-02/2

07-11-2024

M-570.02-EN-AB

## MAINTENANCE

GNR5... is maintenance-free when used as intended.

Though the magnetic float "collects" gradually any magnetizable metal particles that may be present in the medium. To prevent malfunctions, the float should therefore be cleaned of such particles at regular intervals.

To do this, both stopcocks are closed.

The medium in the glass tube can be drained by opening the drain cock.

When reassembling, the seals must be replaced.

### GNR5

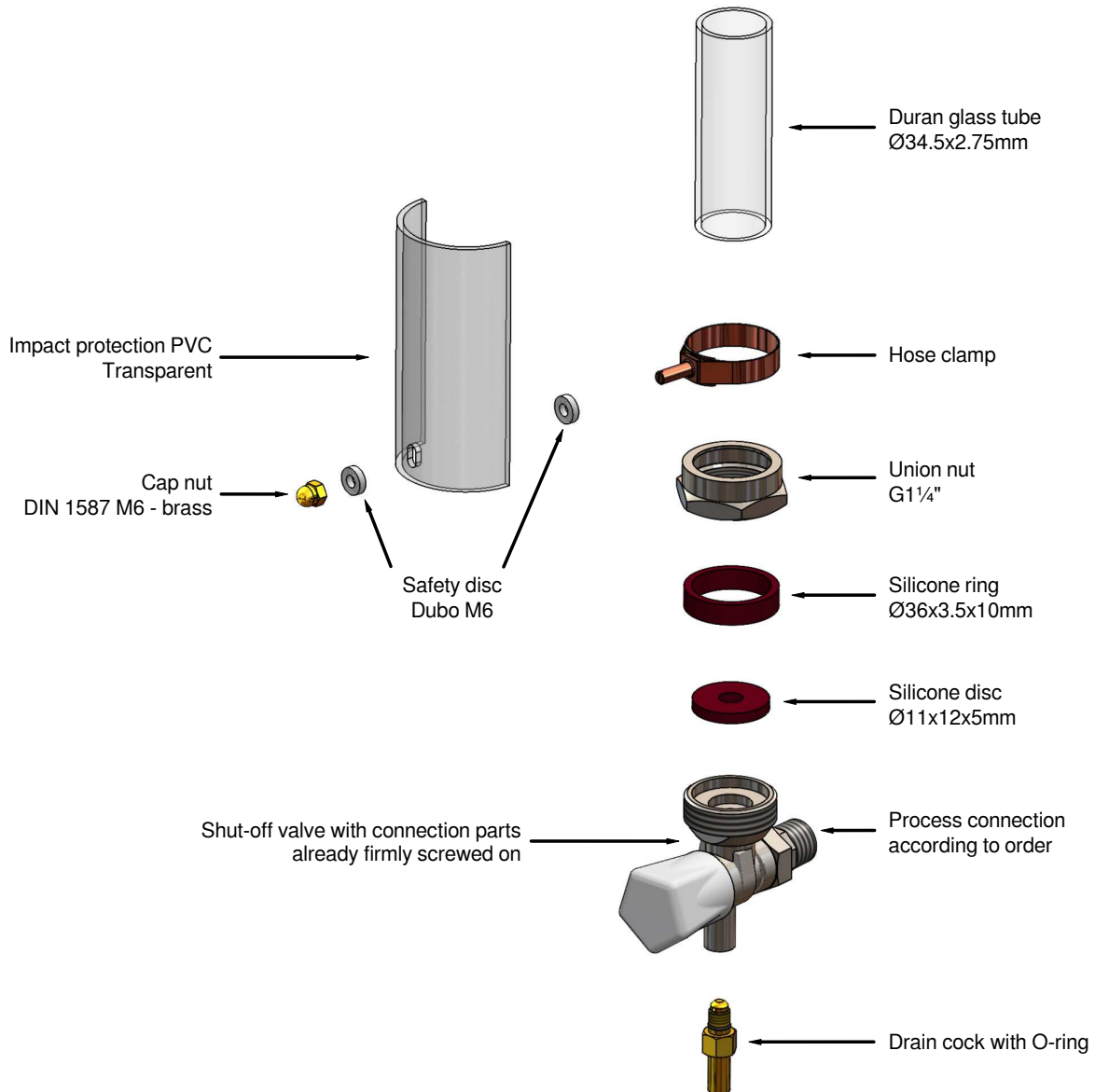

**BAMO** INTERNATIONAL

22, Rue de la Voie des Bans · Z.I. de la gare · 95100 ARGENTEUIL

Tel +33 (0)1 30 25 83 20 Web [www.bamo.eu](http://www.bamo.eu)

Fax +33 (0)1 34 10 16 05 E-mail [export@bamo.fr](mailto:export@bamo.fr)

Sight glass level indicator  
**GNR5 / GRN5C**

07-11-2024

M-570.02-EN-AB

LEV

570-02/3

**GNR5 C**

